

APC International, Ltd.

TEL: +570-726-6961 FAX +570-726-7466 E-mail: sales@americanpiezo.com

Photo:



Standard type of this sensor:

40T-16AW	Catalog # 10-1096
40R-16AW	Catalog # 10-1101
40T-16P	Catalog # 10-1106
40R-16P	Catalog # 10-1111

Specification:

PARTS NUMBER	40T-16	40R-16
Center frequency (kHz)	40.0±1.0kHz	40.0±1.0kHz
Sound pressure level (0dB=0.0002 μ bar) *	≥ 119dB	-----
Sensitivity (0dB vs 1V/ μ bar) *	-----	≥ -65dB
Bandwidth (kHz)	4.0/112dB	3.5/-71dB
Beam angle -6dB	55°	
Driving voltage (RMS) *	20V	
Working temperature (°C)	-30~80	

Dimension(40T/R-16F):

A=16.1±0.3

B=12.0±0.4

C= 9.5±1.0

D=10.0±0.5

E=1.0±0.1

(UNIT: mm)

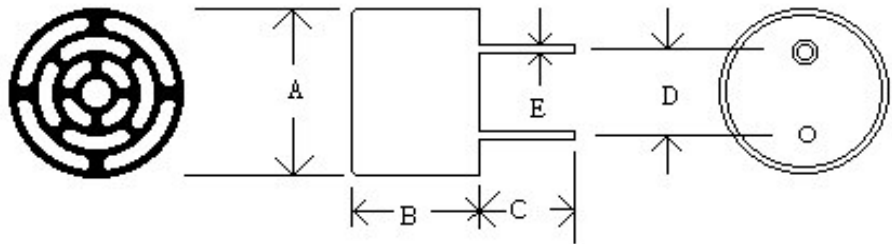

*Sound Pressure Level: 1 dB vs 0.0002 ubar measured at 10Vrms, 30 cm distance

*Sensitivity: 0dB vs 1V/ubar, 30 cm distance

*Maximum Drive Voltage: 30 Vrms or 80 V(peak - peak)

Sound pressure level

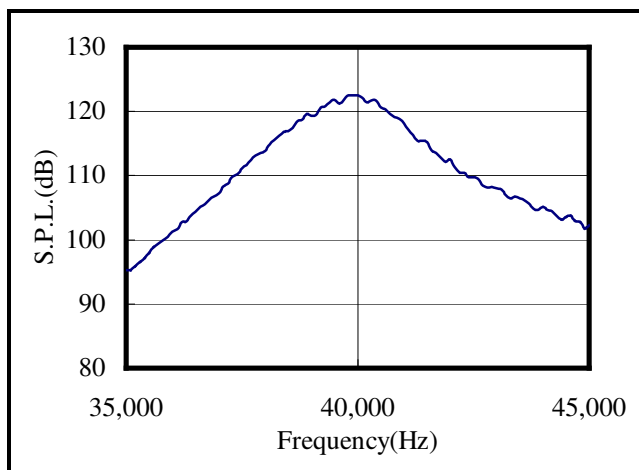

Sensitivity

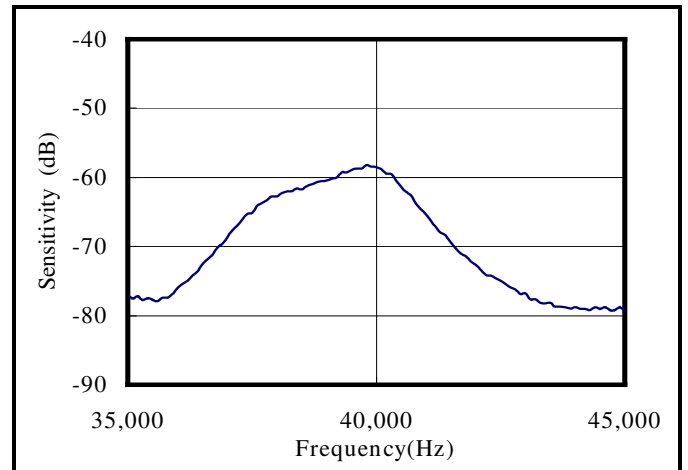

Transmitter impedance

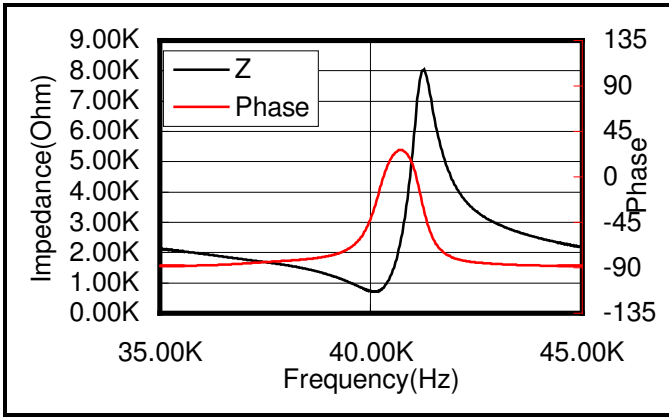

Receiver impedance

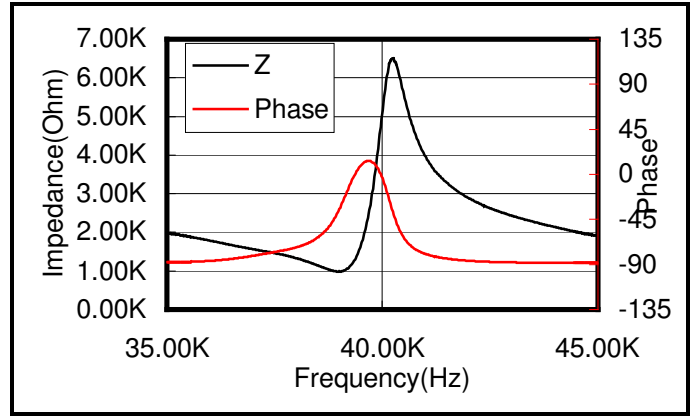

Beam angle of transmitter

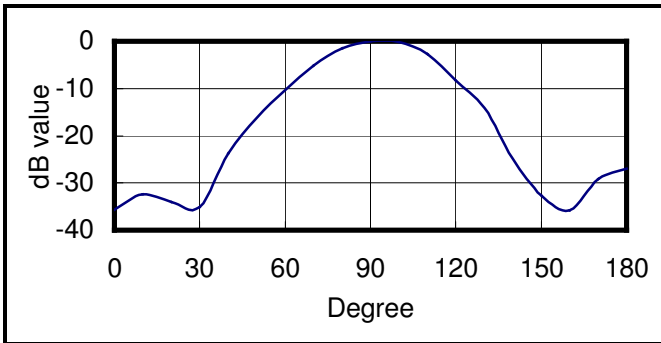

Beam angle of receiver

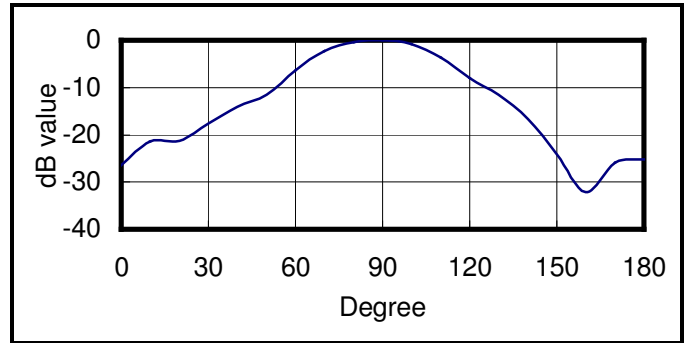

Environment test

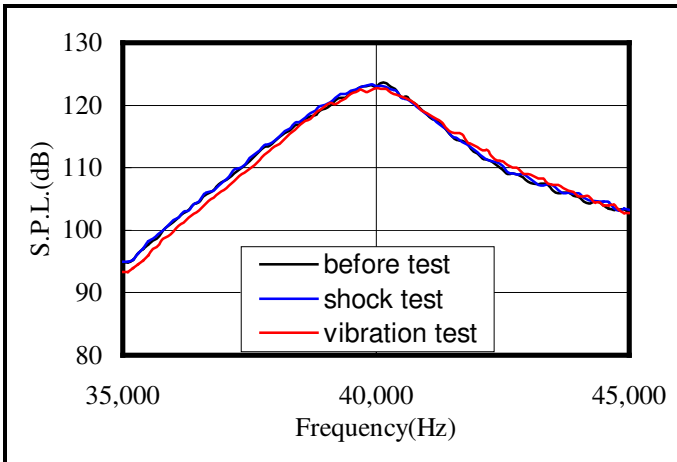

Temperature test

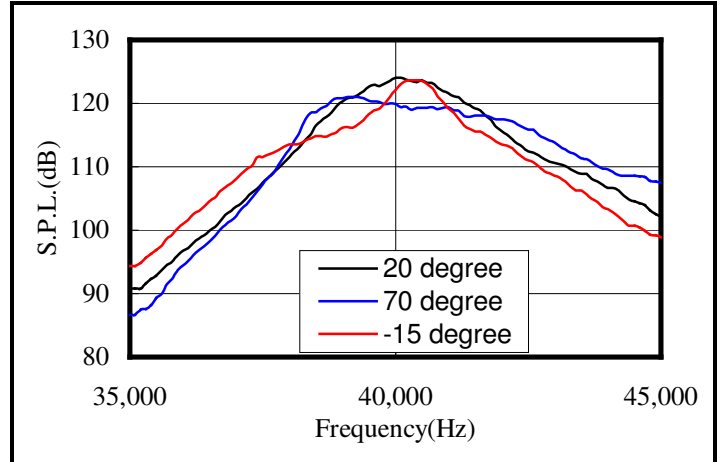

Sensitivity change with load resistance

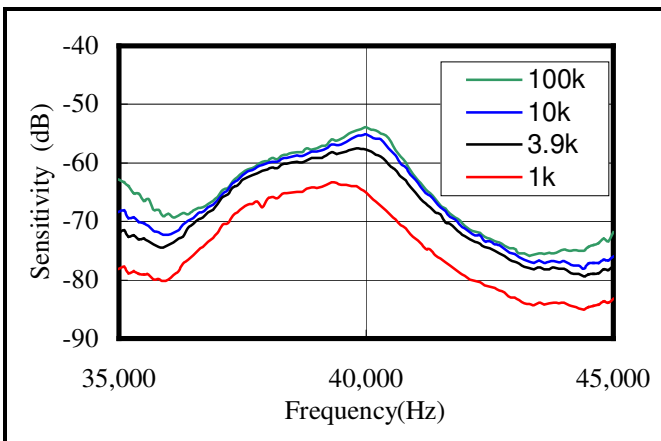

S.P.L. change with driving voltage

